

Stavba: REKONŠTRUKCIA SPIŠSKÉHO HRADU,
ROMÁNSKY PALÁC A ZÁPADNÉ PALÁCE
Objekt: SO.03 - KAPITÁNSKY DOM

Časť: SILNOPRÚDOVÁ ELEKTROINŠTALÁCIA
Stupeň: PROJEKT PRE REALIZÁCIU

ZOZNAM SVIETIDIEL

VŠETKY TYPY SVIETIDIEL UVEDENÉ VO VÝKRESOVEJ DOKUMENTÁCII SÚ PREZENTOVANÉ LEN Z DÔVODU VYŠPECIFIKOVANIA POŽADOVANÝCH SVETLOTECHNICKÝCH, FYZIKÁLNYCH A TVAROVÝCH (DESIGN) VLASTNOSTÍ. TIETO VLASTNOSTI JE NUTNÉ DODRŽAŤ ! AKÚKOLVEK ZMENU UVEDENÝCH VLASTNOSTÍ ODSÚHLASIŤ S GP !

Označ.	Typ ako ... alebo iná adekvátna náhrada	
A	DISANO	41451200 RODIO 1800 3 3W LED BIA CLD CTL GRAFITE
B1	DISANO	16451200 HYDRO T8 920 FL 1X58 CNR-F GRIGIO
	TRIDONIC	DALI predradník 22085286 PCA 1/58 EXCEL
	CLSKBA	Nosič Hydro - ATYP
B2	DISANO	16451100 HYDRO T8 920 FL 1X36 CNR-F GRIGIO
	TRIDONIC	DALI predradník 22085264 PCA 1/36 EXCEL
	CLSKBA	Nosič Hydro - ATYP
B3	DISANO	16451000 HYDRO T8 920 FL 1X18 CNR-F GRIGIO
	TRIDONIC	DALI predradník 22085245 PCA 1/18 EXCEL
	CLSKBA	Nosič Hydro - ATYP
C1	DISANO	41432200 SICURA T5 1725 FL 1X45 ECO CELL GRAFITE
	TRIDONIC	DALI predradník 22176172 PCA 1/49 EXCEL
C2	DISANO	41432300 SICURA T5 1725 FL 1X50 ECO CELL GRAFITE
	TRIDONIC	DALI predradník 22176174 PCA 1/54 EXCEL
C3	DISANO	41432000 SICURA T5 1725 FL 1X20 ECO CELL GRAFITE
	TRIDONIC	DALI predradník 22176178 PCA 1/24 EXCEL
C4	DISANO	41432200 SICURA T5 1725 FL 1X45 ECO CELL GRAFITE
D	DISANO	43181900 KOALA 1537 3 3W LED BIA CLD CTL GRAFITE
E	!TRIDONIC	89600641 LED LE1500 9P130 WW 24V - 90° Z22 W
	TRIDONIC	Napájací zdroj 22185186 LCU 150/24 D010 IP67
F	!TRIDONIC	89600640 LED LE1200 7P130 WW 24V - 90° Z22 W
	TRIDONIC	Napájací zdroj 22185186 LCU 150/24 D010 IP67
G	GOCCIA	4631 NE TRIANGOLO ALOGENO SPOTLED111 black
	CLSKBA	Nosič TRIANGOLO UNI, stojan/záves pre 1/2 svt.
H	GOCCIA	8310 AN KASKO round with guard, 100W, opal glass diffuser
	GOCCIA	3382 AN KASKO Post for round KASKO H=830 mm
Hn	GOCCIA	4491 AN KASKO round with guard, 2x9W, opal glass diffuser, s núdz.modulom
I	DISANO	42724600 GLOBO 1544 MAX 105 S GRIGIO
K	FOSNOVA	2208561300 KING 0856 ESALED 14 7W CLD CELL BIA
Z1	DISANO	Ziarivkové závesné priame/nepriame osvetlenie-14566152 ZENITH 3845 FL 2X35 49 CELF-DO ARG.SAB



1800 - RODIO

POWERLED OTTICA TRITTICA

Corpo Rodio:
Diffusore Rodio:

In alluminio pressofuso, con alettature di raffreddamento.
In vetro temperato sp. 5mm resistente agli shock termici ed agli urti (prove UNI EN 12150-1:2001).
Completo di 6 moduli ottica trittica P=4,2W cad, apertura fascio 25°.
da -30°C a 75°C.
50.000 h

LED:
Temperatura di funzionamento:
Durata di vita:

Powered bianco

IP65IK08

apertura fascio: 25°

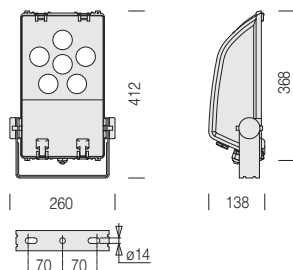

CODICE	COLORE CORPO	CONF. PEZZI	CABLAGGIO	WATT tot.	FLUSSO LUMINOSO	COLORE LUCE
414512-00	grafite	1	CTL	4,2W x 6 LED bianco	135 lm x 6	6000K

Powered colorati

IP65IK08

apertura fascio: 25°



CODICE	COLORE	CONF. PEZZI	CABLAGGIO	WATT tot.	FLUSSO LUMINOSO	COLORE LUCE
414512-71	grafite	1	CTL	4,2W x 6 LED blu	48 lm x 6	-
414512-72	grafite	1	CTL	3,6W x 6 LED rosso	81 lm x 6	-
414512-73	grafite	1	CTL	3,6W x 6 LED giallo	75 lm x 6	-
414512-74	grafite	1	CTL	4,2W x 6 LED verde	139 lm x 6	-

Completo di 2 alimentatori con potenza P=10W a corrente costante A= 350mA.

1800 - Rodio

Accessori

COD. 997920 Gabbia di protez.

Acc. 349 - In tondino di acciaio plastificato per la protezione antiurto.

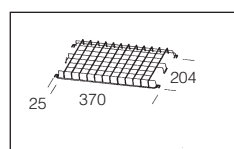
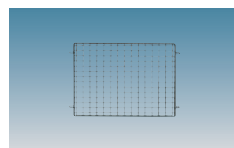

COD. 997915 Attacco palo ø60

Acc. 333 - In alluminio. Consente l'installazione su palo ø60.

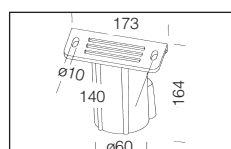

COD. 997916 Attacco palo ø76

Acc. 334 - In alluminio. Consente l'installazione su palo ø76.

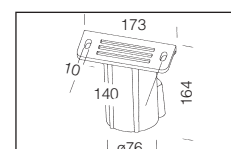

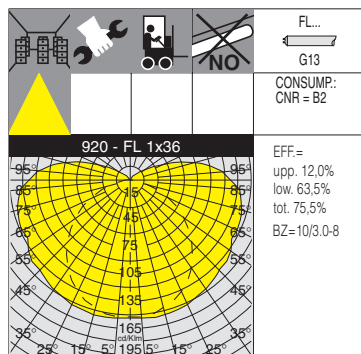
B2

Nissan - Milan

**920 Hydro T8**

		CNR-F	
wattage	colour	weight	code
FL 1x18	grey	1.40	164510-00
FL 1x36	grey	2.10	164511-00
FL 1x58	grey	2.80	164512-00
FL 2x18	grey	1.80	164513-00
FL 2x36	grey	3.40	164514-00
FL 2x58	grey	4.50	164515-00

IP66IK08

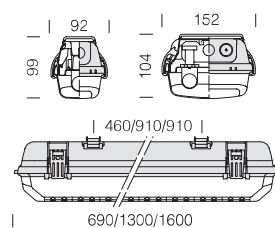

Guarantees a good level of energy saving with a conventional ballast.

(losses B2: 18W = max 8W,
36W = max 7 W,
58W = max 9W).

On request: supplied with knife switch installed, excluded the 1x18 and 2x18 version.

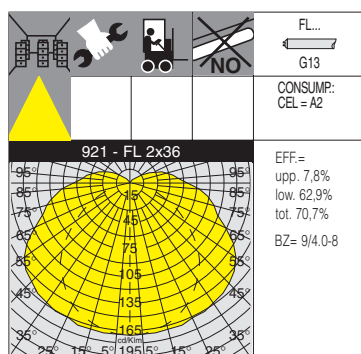
A2**921 Hydro T8 - electronic**

		CEL-F	
wattage	colour	weight	code
FL 1x18	grey	1.40	164530-00
FL 1x36	grey	1.90	164531-00
FL 1x58	grey	2.20	164532-00
FL 2x18	grey	1.80	164533-00
FL 2x36	grey	2.40	164534-00
FL 2x58	grey	3.90	164535-00

IP66IK08

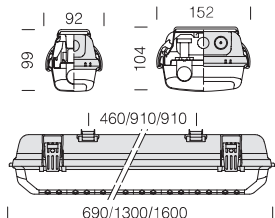

The electronic power supply unit provides approximately 22% energy saving compared with standard units, overvoltage resistance, short circuit protection, flicker-free ignition, no stroboscopic effect, noise-free operation.

On request: supplied with knife switch installed, excluded the 1x18 and 2x18 version.

1725 Sicura recessed - asymmetric

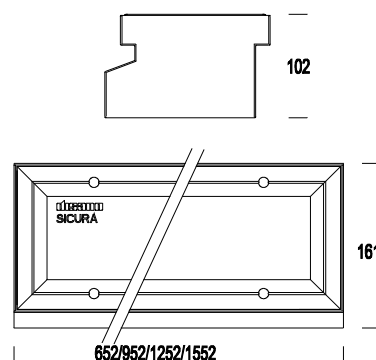

Code	Gear	Kg	Colour	Dimensions	Total Installed Power Capacity	lamp
414320-00	CELL	3.40	graphite	652x161x102	26	FL 1x20 ECO-G5-1650lm-4000K-Ra 1b
414321-00	CELL	4.50	graphite	952x161x102	43	FL 1x37 ECO-G5-3100lm-4000K-Ra 1b
414322-00	CELL	7.00	graphite	1552x161x102	55	FL 1x45 ECO-G5-4100lm-4000K-Ra 1b
414323-00	CELL	7.00	graphite	1252x161x102	60	FL 1x50 ECO-G5-4450lm-4000K-Ra 1b

HOUSING: Supplied with a extrude aluminium frame with die-cast aluminium end caps.

REFLECTOR: Asymmetric made of high-gloss anodised 99.85 aluminium.

DIFFUSER: 5mm thick thermal shock and impact resistant tempered glass.

LAMPHOLDER: Polycarbonate with phosphorous bronze contacts.

ELECTRIC GEAR: 230-240 V / 50-60 Hz power supply with electronic ballast; hard wire, cross-section 0.50sqmm, 90°C heat resistant PVC-HT sheath in accordance with CEI 20-20 standards. 2P terminal block (maximum allowed lead cross-section: 2,5 sqmm).

COATING: Graphite grey polyester powder coating applied, resistant to corrosive and saline environments.

EQUIPMENT: Fibreglass nylon cable gland, Ø ½ " gas.

REGULATIONS: Manufactured in compliance with EN60598 - CEI 34 - 21 standards. The level of protection complies with the EN60529 standard.



1537 - KOALA

POWERLED OTTICA TRITTICA

Corpo Koala:
Diffusore Koala:
LED:
Temperatura di funzionamento:
Durata di vita:

In alluminio pressofuso, con alettature di raffreddamento.
 In vetro serigrafato e temperato.
 Completo di 3 moduli ottica trittica P=4,2W cad., apertura fascio 25°.
 da -30°C a 75°C.
 50.000 h.

Powerled bianco

IP65IK08

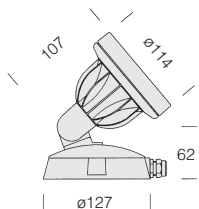

CODICE	COLORE CORPO	CONF. PEZZI	CABLAGGIO	WATT tot.	FLUSSO LUMINOSO	COLORE LUCE
431816-00	argento	1	CTL	4,2W x 3 LED bianco	135 lm x 3	6000K

Completo di alimentatore (inserito nella basetta) con potenza P=3W a corrente costante A=350mA.

Fascio luminoso

5 m (misura indicativa)

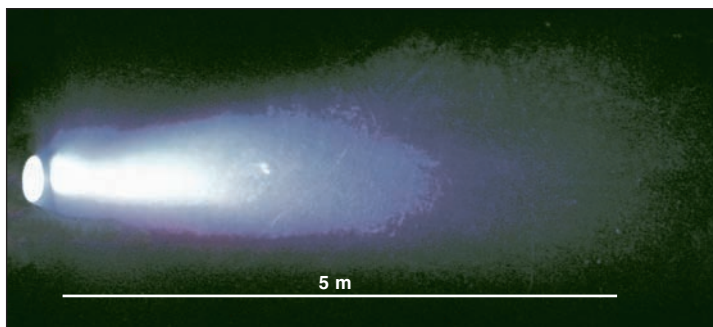
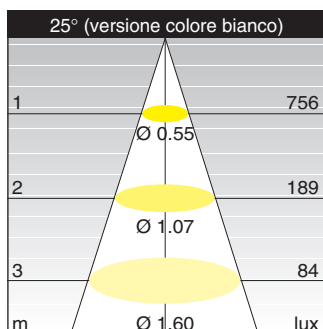

1537 - KOALA

POWERLED OTTICA TRITTICA

1537 - Koala

Accessori

COD. 991336 Supporto a palo

Acc. 120

In nylon f.v. Permette di applicare Koala/Dafne su qualsiasi palo Ø60 e in ogni posizione.



COD. 991331 Tappo per palo

Acc. 115

In nylon f.v. Da applicare a palo Ø60mm (acc. 50). Per la chiusura della sommità del palo.



COD. 991330 Convogliatore

Acc. 114

In alluminio. Permette di convogliare il fascio luminoso in un'unica direzione.

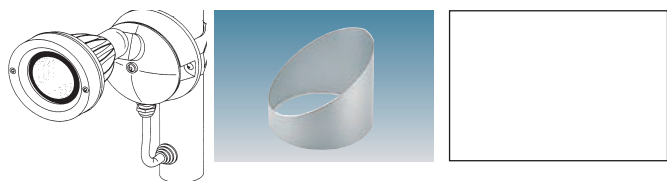

COD. 991335 Picchetto

Acc. 119

In nylon f.v. Permette l'interramento di Koala nel terreno.



COD. 991332 Supporto angolare

Acc. 116

In nylon f.v. Permette di applicare Koala/Dafne su una superficie ad angolo esterno.

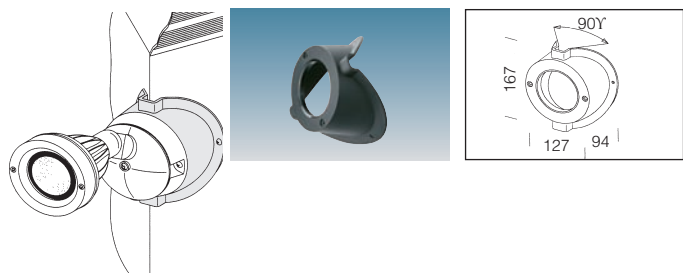

COD. 991334 Morsetto

Acc. 118

In nylon f.v. Permette di applicare Koala su diverse superfici senza fissarlo definitivamente. Apertura del morsetto da min 20 a max 60 mm.



TALEXengine Line

IP20   RoHS**Main features:**

- Complete solution with standard cable and mounting profile, ready for connection
- Optimised system efficiency thanks to directional lighting and integrated heat removal
- Perfect combination of COB LEDs and optics for high quality of light
- Available in different lengths, beam angles and colour temperatures
- Accessories available for mounting and fixing

Applications:

- Chillers in the food industry
- Presentation of merchandise in shelving systems, cabinets, etc.
- Use in luminaires

Materials:

- Cooling profile: anodised extruded aluminium
- End caps: aluminium
- Linear lenses: PMMA
TALEX Z161 FIXING PLATE RZ: PBT
TALEX Mounting bracket: steel
TALEX strain relief: aluminium

Installation:

- Mounting with TALEX mounting plate Z161 RZ or TALEX mounting bracket - adjustable
- Safety extra low voltage (SELV)
- Supplied with cable H03VVH cross-section 2x0.75 mm², white, length 1 m

Classification:

- Ambient temperature: -30 °C to +30 °C
- Max. surface temperature on profile: 60 °C
- Type of protection IP 20
- Protection class III

Standards:

- EN 60598-2-1
- EN 62031

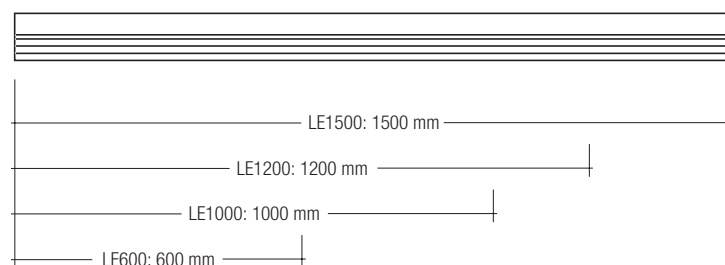
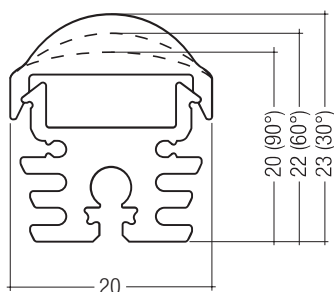
Dimensions with 30°, 60° and 90° linear lenses

IP67     RoHS

TALEXconverter LCU 150 W 12 V outdoor IP67 Constant voltage

Product description

- Constant voltage converter
- Universal input voltage range
- Constant output voltage
- Connection: Cable with end sleeves (length approx. 2,000 mm)
- Polarity identifiers, secondary + red / – black
- Metal casing, encapsulated

Properties

- High efficiency
- Low power loss
- Overtemperature and overload protection
- Short-circuit shutdown feature with automatic restart
- SELV
- Type of protection IP67

Technical data

Rated supply voltage	120 – 240 V
Input voltage, AC	108 – 264 V
Input voltage, DC	120 – 240 V
Rated current (at 230 V 50 Hz)	0.77 A
Mains frequency	0 / 50 / 60 Hz
Efficiency	> 88 %
Max. input power	176 W
λ	0.95
Output voltage	12 V
Output voltage tolerance	+ 10 %
Output current range	1.25 – 12.5 A
Output power	150 W
Output power range	20 – 150 W
Turn on time (output)	≤ 0.5 s
Turn off time (output)	≤ 1 s
Hold on time at power failure (Output)	10 ms
Ambient temperature t_a	-25 ... +50 °C
Max. casing temperature t_c	85 °C
Storage temperature	-30 ... +85 °C
Weight	1.6 kg
Dimensions LxWxH	247 x 69 x 38 mm
Hole spacing D	238 mm

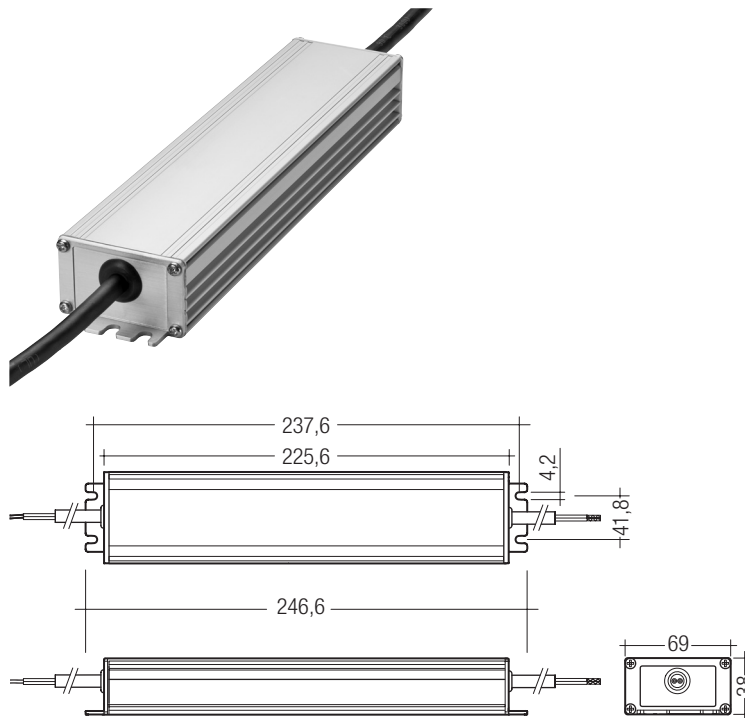

Ordering data

Type	Article number
LCU 150/12 D010	24166331

Packaging: 6 pieces/carton, 120 pieces/pallet

TRIANGOLO ALOGENO 4631 300W R7sIP65   

230-250 V 50-60 Hz

Class I

goccia
ILLUM NAZIONE

Impact test: 6 joules

Electromagnetic compatibility CEE 89/336 - EN 55015 III Ed. - EN 61000 - 3 - 2

Definition and application**Aluminium filleted triangular weatherproof fixture with square aluminium frame, opal glass and articulated bracket.**

To be installed on wall over entrance of shops, homes, buildings.

Lighting source

300W R7s lampholder

Illuminance level: **5000** LumenLife: **2000** hTonality: **2700°K** warmDescription

Housing in die-cast aluminium with back cable box in black polycarbonate, on silicone gasket.

External frame in die-cast aluminium.

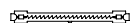

300W R7s

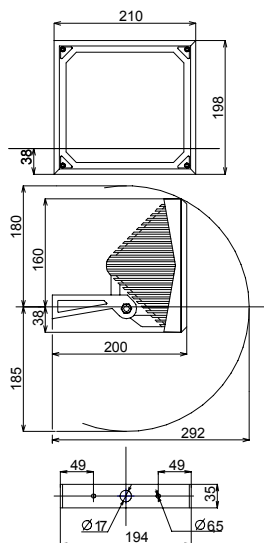

Flat opal glass diffuser.

Gasket: Silicone antiaging rubber

Terminal block: O. Körner 4153317 3 poles

Reflector: polished 99,5 aluminium

Lampholder: Vossloh 400565.01

FinishPickling, phosphochrome, polyester powder coating, UV resistant
+ (only silver) transparent coating UV resistantPhotometryEfficiency $\mu = 62\%$

The diagram of illuminance is round and central.

The polished reflector multiplies illuminance level.

Be careful to install the fitting in position not to be dazzled by the light.

Illumination calculation of your projects on require.

Installation:

Two fixing holes in the fixing steel bracket, galvanized.

Cable entry through the back cable box. PG11 and IP 68 cable gland

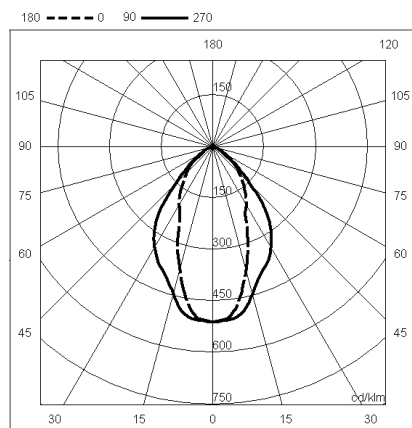

KASKO TONDO PICCOLO 8310 100W E27IP65   230-250 V 50-60 Hz

Class I

Glow wire 960°

Impact test: 6 joules

Test report n.° 04AF00089/1 CENELEC

Electromagnetic compatibility CEE 89/336 - EN 55015 III Ed. - EN 61000 - 3 - 2

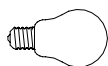
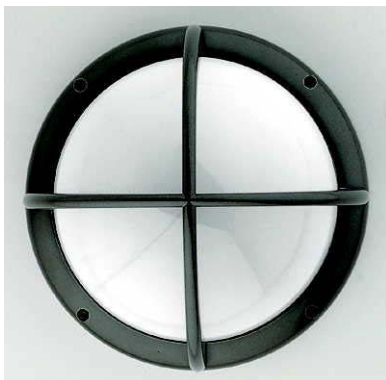
goccia
ILLUM NAZIONE

E27 - 100W

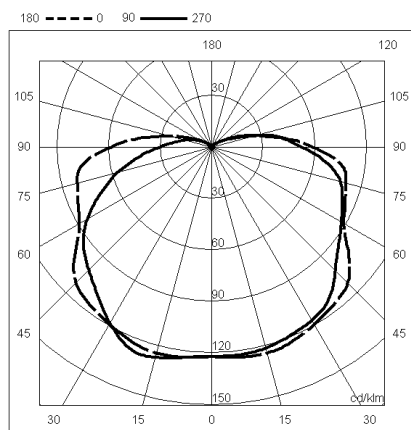
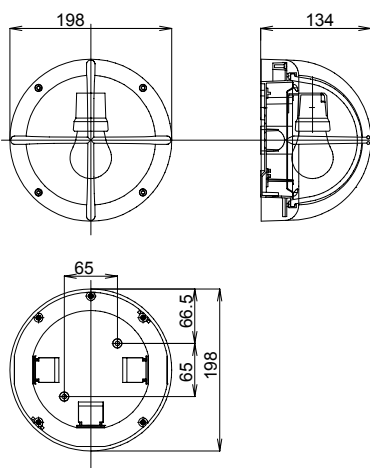
**Definition and application**

Weatherproof round lighting fitting in die-cast aluminium, with cross guard, seamless between guard and installation surface, 4 stainless steel allen key screws, hemispheric opal glass diffuser, "U" gasket. To be installed on wall, ceiling or on garden post.

Designed for private or public areas, it may be installed on walls, with inclined support too, or ceilings, or post for garden use. It can be safely used on flammable surfaces.

Lighting source:

E27 lampholder 100W

Illuminance level: **1200** LumenLife: **1000** hTonality: **2700°** K warm**Description**

Housing and cover in die-cast aluminium.

Stainless steel allen key screws M5 and 3,7x10x1 polyethylene washers.

Sodic calcic tempered opal glass diffuser, smooth inside

Silicone gasket, corrosion resistant

Tripolar Terminal block, in red nylon with glass fibre

O. Körner 4176328 + O. Körner OK 4176327

Componentsholder reflector in 99,8 aluminium, covered with protective pellicle.

Fixing cross-head screws

Lampholder: VOSSLOH E27 ceramic, on steel bracket with M3x6 screws.

Wiring: mm² 1 cables, silicone insulator.**Finish**Pickling, phosphochrome, polyester powder coating, UV resistant
+ (only silver and anthracite) transparent coating UV resistant**Photometry**Efficiency $\eta = 67\%$

The polar diagram shows a diffuse lighting: the lamp, oriented downwards, gives a very good lighting without the lampholder shade.

Installation:

With two fixing holes in the base

Cable entry from the rear, from the side, or from the top through PG11 and IP 68 cable gland

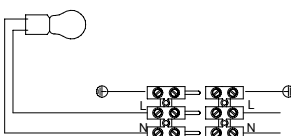

Wiring diagram

Aluminium post

Half cylindrical section aluminium post, with hemispherical header filleted with the fixture; half-round ground base with three ground fixing holes.

- 3382 Vertical post – height: 830 mm

Post made from extruded aluminium, header and base from die cast aluminium.

Threaded rods and nuts M8 join together the three elements.

The fixture fixing holes are: one in the header, the other one in the pole itself. Fixing screws for fixture (4,8x16) are supplied.

Large hole for cabling.

Base with earthing screw hole.

The base of the post is to be locked to ground by "fischer" systems, according to the drawing.

Painting

After "phosphochrome" priming treatment the whole post is covered with anti electrostatic teflon paints.

Junction box and its contents

Recessed junction box made by unpainted polycarbonate, cover made from die cast aluminium. It has four wiring holes and rubber grommets with three round wiring cut-outs.

Gasket in extruded rubber by PIGOMMA.

Ø mm 3,5.

Terminal block in white nylon, 4P for 4 mm² section wire.

Terminal block for fuse in white nylon, 1P for 2.5 mm² section wire.

Fuse 5x20, 250 V, 200mA.

Earthing silicone cable yellow/green in colour 1 mm² section, length 200 mm, fixing screws stainless steel 3.5 mm cross-head.

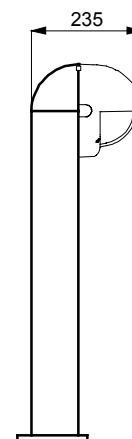
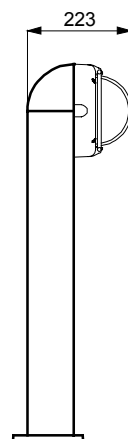
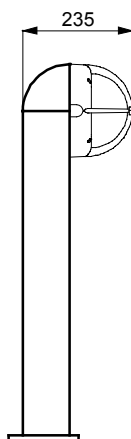
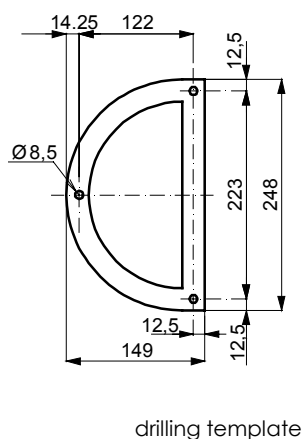
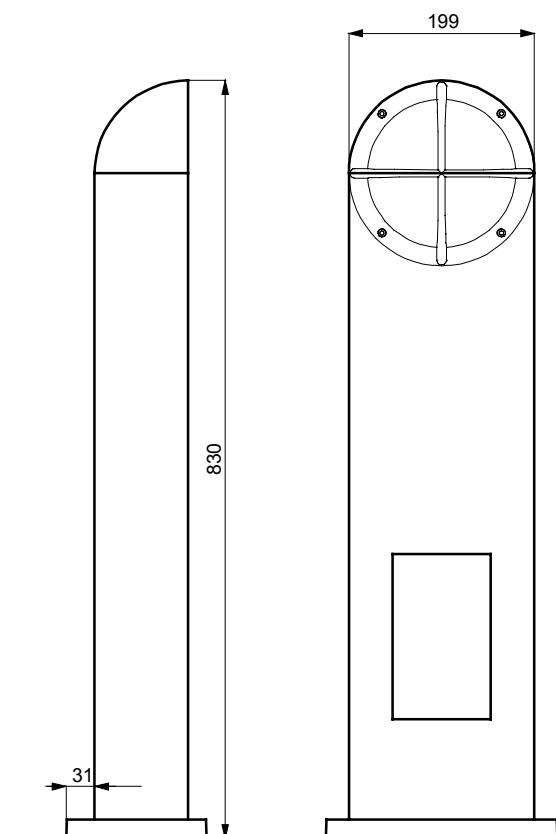

1544 Globo

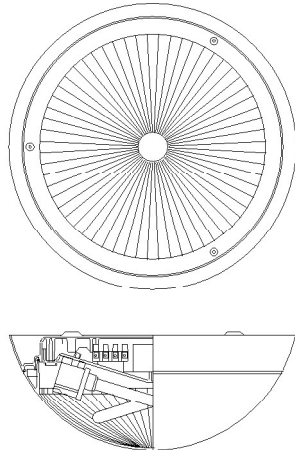

Code	px no. pack.	Gear	Kg	Watt	Base	Colour	Dimensions	Total Installed Power Capacity	Lamp
427246-00	1	S	1.40	INC 100	E27	grey	0x0x124 R300		270
427247-00	1	CNL	1.70	FLC 2x9S	G23	grey	0x0x124 R300	28	400

Housing: In vandal resistant and V2 self-extinguishing polycarbonate, UV stabilized.

Diffuser: In anti-glare, vandal resistant and V2 self-extinguishing polycarbonate, UV stabilized, smooth outside, dustproof.

Reflector: In polished aluminium and white polycarbonate.

Lampholder: In polycarbonate, phosphor bronze contacts. Socket G23; E27.

Electric gear: 230V/50Hz power supply. Hard wire 0.75 sqmm cross-section and PVC-HT sheath resistant up to 90°C according to CEI 20-20 standards or hard silicone wire with glass braid, 0.75 sqmm cross-section. 2P or 2P+T terminal block with maximum allowed lead cross-section of 2.5 sqmm.

Equipment: Gasket in environment-friendly material. Cable gland in fiber glass nylon R 1/2 gas thread (cable min. R 9 max. R 12).

Regulations: Produced according to applicable IEC 598 - CEI 34 - 21 standards, IP65 degree of protection according to EN 60529 standards. Double insulation.

Lamp: Complete with lamp. INC100; FLC2x9s.

King

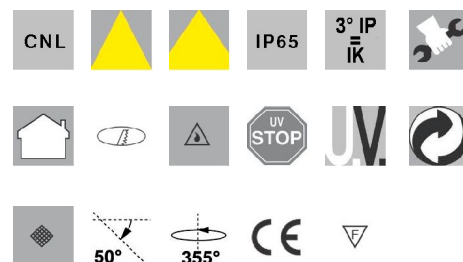
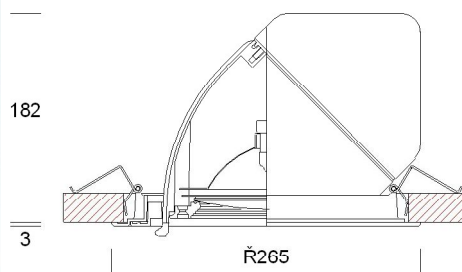

Code	Gear	Base	Volt	Watt	Lamp	Reflector	Kg	Colour	Dimensions	Lamps	Total Installation
85111	CTL	GY6,35	12	50	ALO	S	4.2	white	0x0x185	3000k - 930lm - 100	
85179	CTL	GY6,35	12	50	ALO	S	4.2	met. silver	0x0x185	3000k - 930lm - 100	
85212	CNL	E27	230	75	ALO	M	3.6	white	0x0x185	3000k - 1100lm - 100	
85278	CNL	E27	230	75	ALO	M	3.6	met. silver	0x0x185	3000k - 1100lm - 100	
85414	CNRL	G24d-1	230	13	FLC-D	L	3.8	white	0x0x185	3000k - 900lm - 1B	
85476	CNRL	G24d-1	230	13	FLC-D	L	3.8	met. silver	0x0x185	3000k - 900lm - 1B	

King is a recessed floodlight designed to provide a solution to the lighting of environments requiring a high degree of protection.

Housing: Adjustable-angle, made of die-cast aluminium.

Reflector: High-performance oxidised and polished aluminium.

Diffuser: Tempered glass protection shield.

Coating: Humidity-resistant acrylic-resin liquid paint, UV-stabilised.

Lampholder: Ceramic with silver-plated contacts, or polycarbonate with phosphor bronze contacts.

Electric gear: 230V/50Hz power supply. Flexible silicone insulated wire terminated with admiralty brass clamps, with fibreglass braid, cross-section: 1.5 sqmm. 2P+T terminal block (with plug-socket connector).

Standard supply: Includes adjustable steel bracket. Hinge opening of the glass holding ring for easier maintenance.

Regulations: Manufactured in accordance with standards EN60598 – CEI 34 –21. Degree of protection in accordance with standards EN60529.

Lamps: halogen, compact fluorescent energy-saving lamps included.

ZENITH

Žiarivkové závesné priame/nepriame osvetlenie

[Technical Details](#)
[Download](#)
[Accessories](#)

Housing: Extruded aluminium with die-cast end caps.
 Diffuser: Clear, V2 self-extinguishing, UV-stabilised polycarbonate. The smooth outside finishing facilitates cleaning, essential to ensure maximum lighting efficiency at all times.
 Coating: Metallic silver or polished white polyester resin powder coating, resistant to corrosion and to saline environments.
 Lampholder: Polycarbonate with phosphorous bronze contacts.
 Electric gear: 230V240-50/60(CELL) power supply with multiwatt ballast. Hard wire, cross-section 0.50 sqmm and high-temperature resistant (up to 90°C) PVC-HT sheath, in accordance with CEI 20-20 standards.
 2P+T terminal block (maximum allowed lead cross-section: 2.5 sqmm).
 Standard supply: The snap-on optic unit remains attached by safety cords. Quick connectors for electrical line. 3.5° protection fuse.
 Cover: Optionally, direct light only using acc. 526
 Regulations: Manufactured in compliance with EN60598 - CEI 34 - 21 standards. The level of protection complies with the EN60529 standard.
 Emergency version: In maintained version. In the event of a black-out a single lamp connected to the back-up circuit stays on. Run time 60 minutes.
 On request: A "Main Control System" to supervise the emergency versions (see chapter).
 On request: versions with 3-hour battery life.
 In case of mounting in a continuous line order should include fixtures with subcode 0072



Articles

Code	Gear	Version	Kg	Watt	Base	Lamps	Colour
145664-52	CELF-DO	DIMM.	7,5	FL 2x35/49	G5		White
145661-52	CELF-DO	DIMM.	7,5	FL 2x35/49	G5		Al. Track